

Available colours W K

DHUSW

Technical Data

Holding force	600 N
Type (Embedded / Surface mounted)	E
Delay time	—
Closing delay time	—
Opening delay time	—
LED	—
Door status	—
Fire	Yes

Electrical Data

(at 20°C)

Coil type	W
Electrical information	12V/24V DC
Connection	Switch
Duty DC	ED 100%
Rated operational voltage tolerance	+/- 10%
12V DC (Initial)	—
12V DC (Maintenance)	170 mA
24V DC (Maintenance)	85 mA
Power	2W
Transient voltage suppressor (TVS)	Yes

Electric Connection Scheme

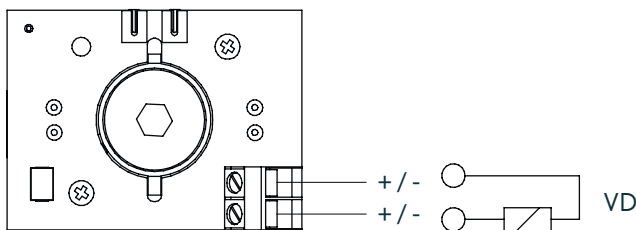

Product certificate

Regulation	(UE) 305/2011						
Normative	UNE EN 1155:1997						
CPR certificate	0370-CPR-1178						
Classification	<table border="1" style="display: inline-table;"><tr><td>3</td><td>5</td><td>3/4</td><td>1</td><td>1</td><td>3</td></tr></table>	3	5	3/4	1	1	3
3	5	3/4	1	1	3		
Normative	—						
Classification	—						
Low voltage directive	2014/35/UE						
Directive (EMC)	2014/30/UE						
RoHs Directive	2011/65/UE						
REACH regulation	1907/2006						

Counterplate

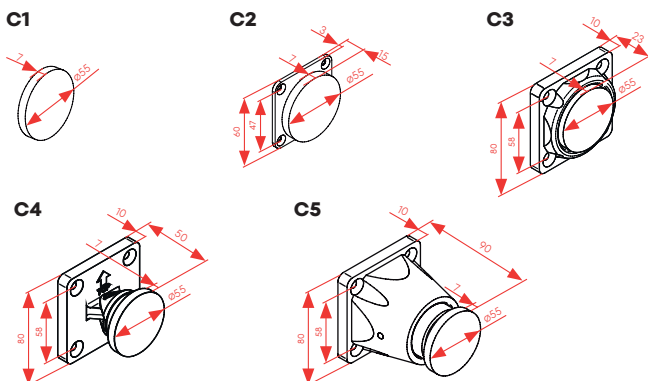

Complement / Supplement

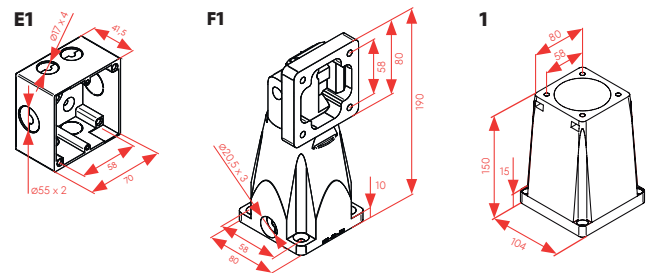

Available colours W K